

# PRODUCT INFORMATION PACKET

FASCO®

Model No: D1061

Catalog No: D1061

OEM Replacement Motor, 1/20 HP, 1 Ph, 60 Hz, 115 V, 1550-1300-1050 RPM, 3 Speed, 4.4" Diameter, OAO



Regal and Fasco are trademarks of Regal Rexnord Corporation or one of its affiliated companies.

©2025 Regal Rexnord Corporation, All Rights Reserved. MC017097E

RegalRexnord



**Nameplate Specifications**

Phase	1	Output HP	1/20 Hp
Output KW	0.04 kW	Voltage	115 V
Speed	1550-1300-1050 rpm	Service Factor	1
Frame	4.4	Enclosure	Open Air Over
Thermal Protection	Thermally Protected	Efficiency	32 %
Ambient Temperature	40 °C	Frequency	60 Hz
Current	2.0-1.7-1.4 A	Duty	Air Over
Insulation Class	A	UL	Recognized
CSA	Y	CE	N
Number of Speeds	3		

**Technical Specifications**

Electrical Type	Shaded Pole	Starting Method	Across The Line
Poles	4/6	Rotation	Counterclockwise Shaft End
Mounting	Extended Studs	Drive End Bearing	Sleeve
Opp Drive End Bearing	Sleeve	Frame Material	Na
Shaft Type	Flat	Overall Length	7.61 in
Shaft Diameter	0.500 in	Shaft Extension	2.75 in
Connection Drawing	SEE OUTLINE	Outline Drawing	71086730

This is an uncontrolled document once printed or downloaded and is subject to change without notice. Date Created:02/10/2025

4

3

2

1

OPPOSITE LEAD END

LEAD END

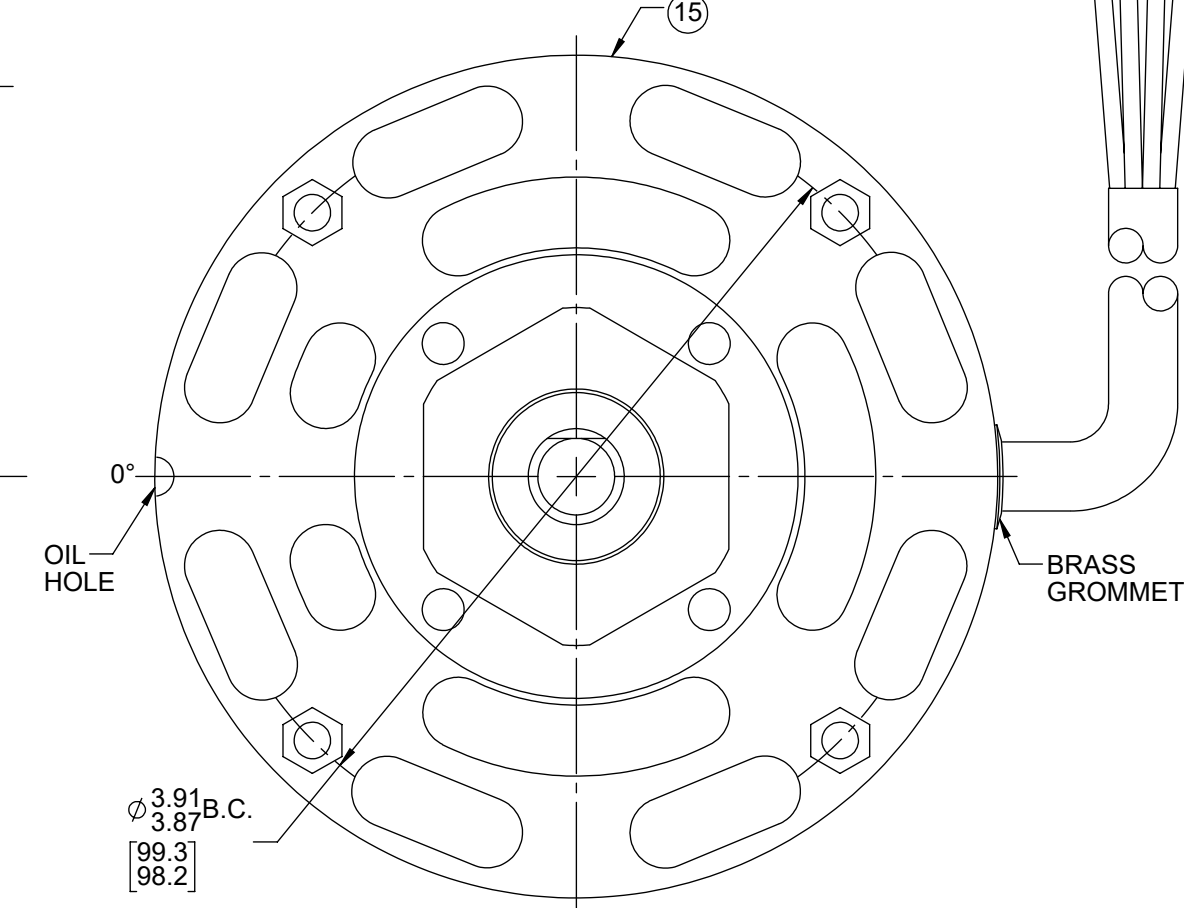
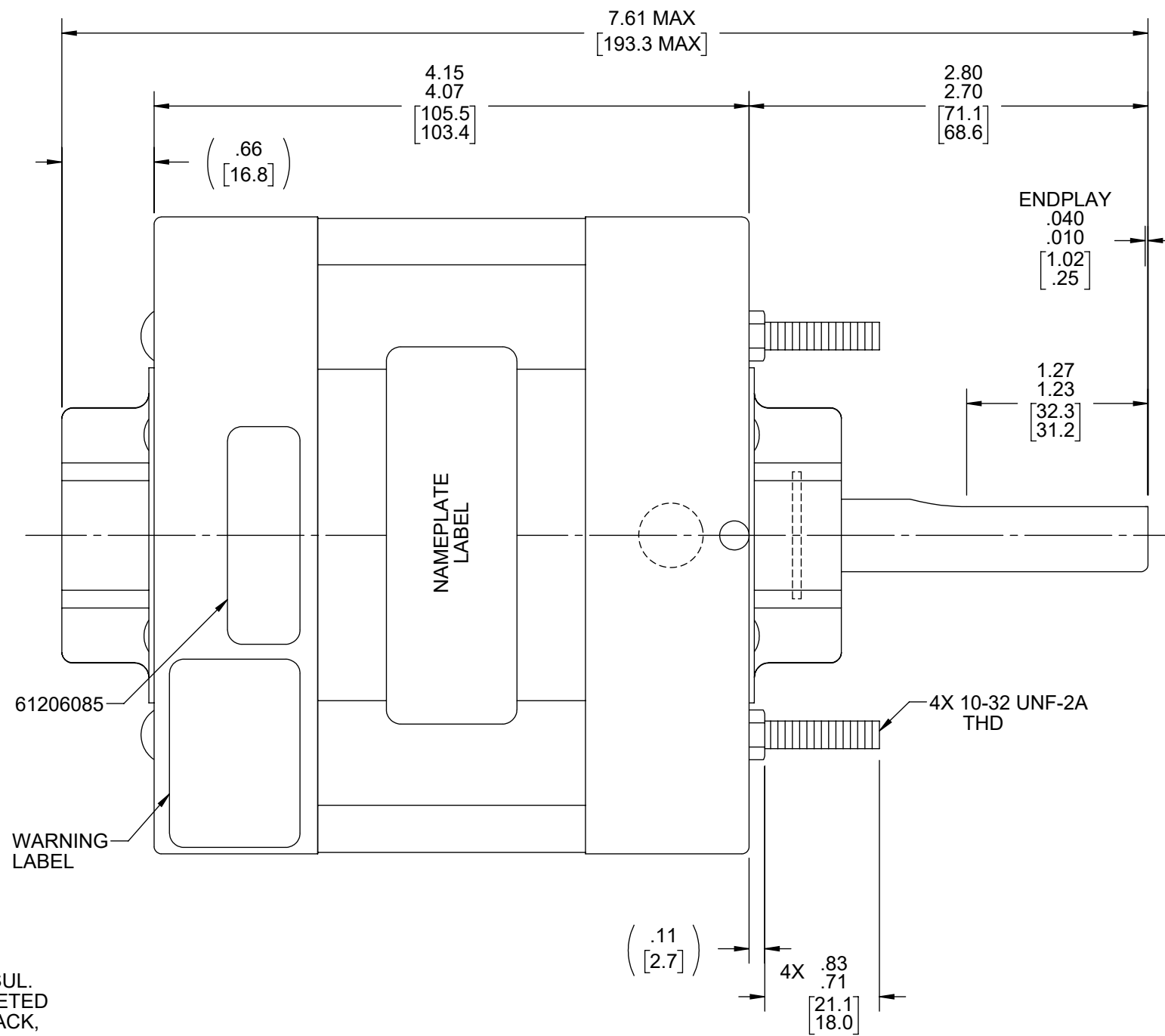
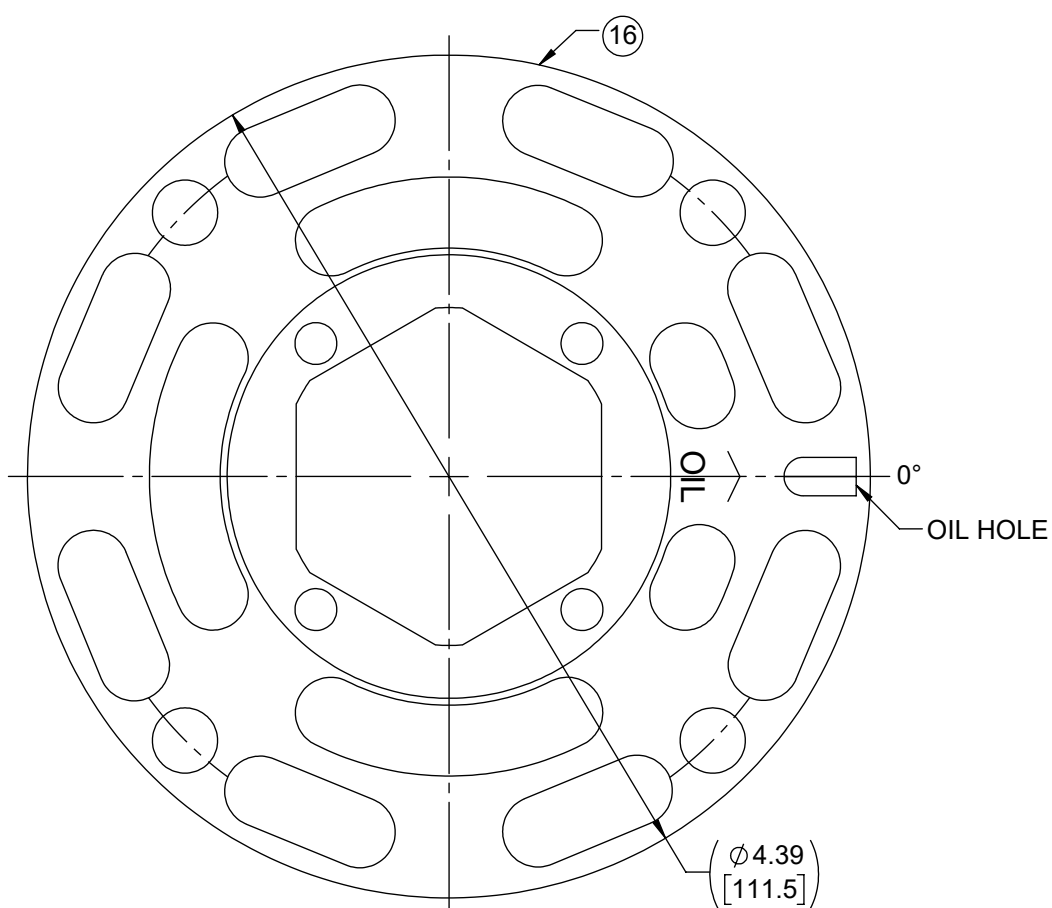

LEAD MATERIAL  
18 GA. 105°C 2/64 INSUL.  
SJTO, 4 COND. JACKETED  
THERMO. WHITE, BLACK,  
BLUE, AND RED  
18.00/16.00 [457.2/406.4]  
6.25/5.75 [158.8/146.1] SPLIT  
.56/.44 [14.2/11.2] STRIP

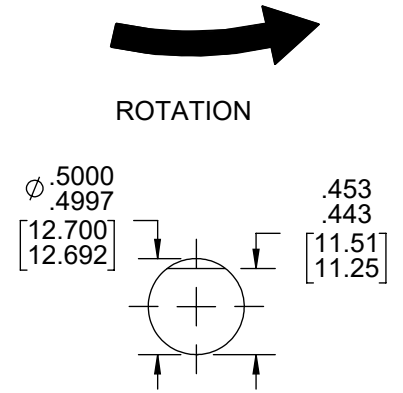

- NOTES:
- THRU AIR SPACING BETWEEN WIRE AND METAL .063 [1.600] MIN.
  - SHAFT IS BONDERIZED.
  - FOR WASHER SET-UP, SEE CHART C6000279, DETAIL "H".
  - EDGE OF JACKET MUST BE INSIDE COVER.
  - TIE BOLT TORQUE TOLERANCE 7 - 10 IN.LBS.
  - ROTOR FREENESS TO BE WITHIN 1 OZ.IN.
  - LOCATE TOP LABEL, 61206085, AT 0° AS SHOWN TO READ RIGHT FROM LEAD END OF MOTOR.
  - LOCATE WARNING LABEL, 61305568, AS SHOWN TO READ RIGHT FROM LEAD END OF MOTOR.
  - MOTORS MUST START WITH 90 VOLTS APPLIED TO LOWEST SPEED.
  - PLACE PAMPHLET, 61224579, IN CONTAINER WITH MOTOR.
  - SEE PACKAGING MANUAL PAGE 2 FOR PACKAGING PROCEDURE.
  - PACK 1 PER CONTAINER, 40 CONTAINERS PER LAYER, 6 LAYERS PER PALLET, 240 MAX. PER PALLET.
  - SEE DRAWING 87856076 SHEET 1 FOR PALLET LAYOUT.
  - CENTER LABEL, 61225914, ON END OF CONTAINER.
  - CARTON LABELS MUST ALL FACE ONE DIRECTION TOWARD THE OPEN END OF THE PALLET, PER 88834408.
  - NO PACKAGING TAPE OVER CARTON LABEL.

61305568

**SAFETY WARNING**  
This motor must be grounded in accordance with local or national electrical codes to prevent possible injury due to electrical shock

**AVERTISSEMENT DE SECURITE**  
Ce moteur doit être fondée sur conformément à la réglementation locale ou national électrique codes pour prévenir d'éventuelles blessures en raison de choc électrique

61206085

TOP

00464072

00464516

**FASCO™**

Assembled in Mexico  
No. 71086730 TYPE U8 AO PH 1  
115 V 60 Hz 2.0-1.7-1.4 A

Model D1061  
1550-1300-1050 RPM  
Thermally Protected OSB

1/20 HP  
Max Amb:40°C  
LR6319

CONNECTION DIAGRAM  
WHITE ----- LINE  
BLK-HI ----- LINE  
BLUE-MED ----- LINE  
RED-LO ----- LINE

61299553

CUSTOMER:	FASCO DIAT.	APPLICATION:	DIST. SALES	HI-POT TEST 2000 VOLTS MAX LEAKAGE CURRENT 5 mA								
CUSTOMER PN:	D1061	MOTOR WEIGHT:	8.50 LBS.									
		ENVIRONMENT:	DRY									
MOTOR TYPE SHADED POLE				REFERENCE SAMPLE								
B	LA	FR	A	S	C	E	B	A				
00	08	10	V	08	EN	7	8	0				
TYPICAL PERFORMANCE AT 115 VOLTS 60 HZ 1 PH 1/20 HP				* BELOW BREAK								
MOTOR SPEED	IDLE			LOADED			LOCKED		BREAK			
	RPM	AMP	WATT	IN OZ	RPM	AMP	WATT	IN OZ	IN OZ			
	HIGH	1740	1.7	100	38	1550	2.0	138	16	2.7	172	45
	MED.	1710	1.2	65	30	1300	1.7	110	14	1.9	120	33
LOW	1730	.9	50	18	1050*	1.4	88	12	1.5	90	24	

PRODUCTION TEST AT IDLE 115 VOLTS 60 Hz		MOTOR SPEED
AMP	WATT	
1.87 - 1.53	110.0 - 90.0	HIGH
1.32 - 1.08	71.5 - 58.5	MED
.99 - .81	55.0 - 45.0	LOW

DRAWING REVISION AC	REVISION BY SDM	REV DATE/DATE 3/31/2022	TOLERANCES (EXCEPT AS NOTED): DEC. INCH mm ANGLE .X ±0.1 [±3] ±1° .XX ±0.01 [±0.3] .XXX ±0.005 [±0.13] .XXXX ±0.0005 [±0.013]	DRAWN BY SDM		Regal Beloit America, Inc.
REQUEST NUMBER ECR-0216621	APPROVED BY MLS	DATE 3/31/2022	REMOVE BURRS & BREAK SHARP EDGES: .003/.015 [.08/.38] X 45° CORNER FILLETS: R.02 [.5] MACHINED SURFACES: ±.25/mm 3.2 INCH/mm DIMENSIONS IN [BRACKETS] ARE FOR REFERENCE ONLY	DATE 8/31/2017		
REQUEST NUMBER DESCRIPTION CHANGE N/P FASCO LOGO TO FASCO TM				APPROVED BY SED	DESCRIPTION OUTLINE MOTOR ASSY	
COPYRIGHT (PER REVISION DATE) REGAL BELOIT AMERICA, INC. ALL RIGHTS RESERVED. PROPRIETARY AND CONFIDENTIAL INFORMATION - THIS DOCUMENT IS THE PROPERTY OF REGAL BELOIT AMERICA, INC. (OWNER) AND CONTAINS OWNER'S PROPRIETARY INFORMATION. ANY PERSON, CORPORATION OR OTHER FIRM RECEIVING IT IS DEEMED, BY RECEIVING IT, TO AGREE THAT IT, AND/OR ANY PART OF IT, SHALL NOT BE DISCLOSED TO ANY PERSON, CORPORATION OR OTHER ENTITY, DUPLICATED, AND/OR USED, EXCEPT AS EXPRESSLY APPROVED IN WRITING IN ADVANCE BY OWNER. THIS DOCUMENT SHALL BE RETURNED TO OWNER UPON REQUEST. IT MAY BE SUBJECT TO CERTAIN RESTRICTIONS UNDER APPLICABLE EXPORT CONTROL LAWS AND REGULATIONS.				DATE 8/31/2017	MATERIAL	PROCESS/FINISH GRAY
THIRD ANGLE PROJECTION			SIZE C	DRAWING NUMBER 71086730	SHEET 1 OF 1	